

Courses & Dist^{es}

S 33 E 68	} Down Juniatta
N 68 E 6	
N 33 W 33	
N. 38. E. 120	
N. 63. E. 54.	
N. 36. W. 78.	
<u>S 33. W. 185.</u>	

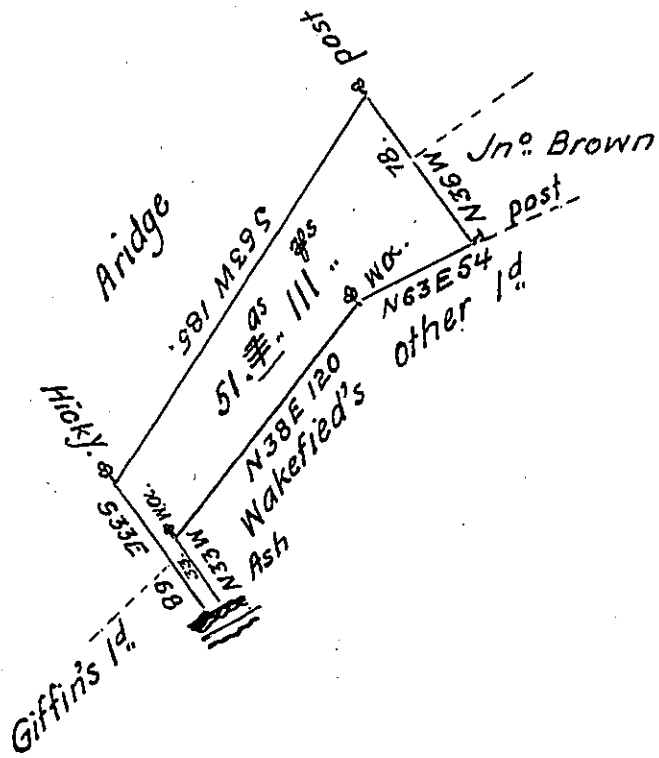

The Draught of a tract of land Situate in Wayne township Cumberland County containing fifty one acres & ~~seven tenths of an acre~~ ^{one hund^d. Eleven per^{ts}} & the usual Allowance of Six ¹/₁₀₀ Cent. for roads &c^o Surveyed for John Wakefield August the 9th 1784 in pursuance of a Warrant from His Excellency the President of the Supreme Executive Council Dated July the 1st 1784.

Ja^s Harris D^S.

John Lukens Esq^r Surv^r Gen^l.

New Mifflin

IN TESTIMONY that the above is a copy of the original remaining on file in the Department of Internal Affairs of Pennsylvania, made conformably to an Act of Assembly approved the 16th day of February 1833, I have hereunto set my hand and caused the Seal of said Department to be affixed at Harrisburg, this twenty-seventh day of May 1907

Henry Howell
Secretary of Internal Affairs.